



Office of the Governor

MICHELLE LUJAN GRISHAM

FOR IMMEDIATE RELEASE

June 22, 2022

State deploying all available resources to mitigate flood danger in communities affected by fires

Residents encouraged to take steps to prepare

SANTA FE – The state, in close coordination with local and federal partners, continues to take action to prepare and protect communities who may be affected by above-average flooding during the monsoon season.

Communities on and downstream from the Hermits Peak/Calf Canyon, McBride, and Cerro Pelado fires are especially at risk for flash flooding, as burned areas are unable to absorb rainfall which can result in large amounts of water and debris being carried downstream. Risk will be variable across all fires and will change throughout the rainy season. Please follow National Weather Service updates and local weather reports for up-to-date information.

Rainfall has occurred in burn scar areas throughout the week, but no severe flooding or damage has been reported. However, as soil becomes saturated, the potential for flash flooding increases. Residents should remain vigilant as the monsoon season progresses.

These areas should operate under the “Prepare, Watch, Warning” flood warning system:

Preparing:

- Monitor TV, radio, reliable social media channels, and phones for real-time weather
- Ensure your phone is enabled to receive emergency alerts
- Identify higher ground
- Plan your evacuation route or routes
- Call 800-432-2080 if you know you will need assistance should an evacuation be needed (for example, elderly, disabled or no transportation)
- Have an emergency supply kit ready to go with enough supplies to last each family member at least 3 days, including:
 - Food and water
 - Change of clothes
 - Important documents
 - Medicine
 - Pet supply needs

Watch:

- Place all identified items in vehicles in preparation for evacuations
- Follow local media, local flooding alerts, and county emergency notifications

Warning:

- Evacuate immediately if told to do so by local officials
- If evacuation is not possible, seek higher ground – walk upslope or get on the roof if necessary
- DO NOT attempt to cross flooded roadways on foot or in a vehicle. If you come across a flooded roadway, turn around and search for higher ground

Keep in mind: conditions may change rapidly. If you feel that it is time to evacuate, do so immediately, regardless of receiving notification from officials.

Residents in the area may check the Hermits Peak/Calf Canyon post-fire planning map [here](#) for information about their flood notification status. This map is continually being refined to increase specificity.

In preparation for flooding, residents may use sandbags to prevent water from entering structures. A video on how to use sandbags is available [here](#). Most homes will only need between 25 and 40 sandbags for adequate protection. Sandbags are useful in low-flow situations and will not protect your home in the case of heavy flooding – you should still evacuate immediately if told to do so.

The Department of Transportation and National Guard are working to provide sandbags to residents at multiple locations in San Miguel and Mora counties and have already delivered 2,000 tons of sand and distributed nearly 100,000 sandbags.

Work to protect infrastructure and remove debris that could be carried by floodwaters is ongoing. State agencies, as well as the U.S. Army Corps of Engineers, are actively working to clear out culverts and bridge areas of debris.

This group is also placing boulders and barriers in strategic locations to mitigate flash flooding.

INFORMATION TOOLKIT:

For your information and reporting purposes, attached please find:

- Flyers in both English and Spanish on how to be prepared for flash flooding
- Flyers in English and Spanish on how to effectively use sandbags
- Flyers in English and Spanish on the three levels of the flood warning system
- Flyers on how to turn Severe Weather Alerts on both iPhones and Androids

###

FLOOD WARNING SYSTEM

Burned areas are at high risk for flash flooding; even a distant rainstorm can quickly flood your location. Know the warning system and be ready to evacuate

PREPARING FOR RAIN: BE ALERT

Prepare yourself and your family for potential flooding evacuation

- ✓ Monitor TV, radio, reliable social media channels, and phones for real-time weather
- ✓ Check your area's flood plain map (<https://hermits-peak-calf-canyon-fire-resources-nmhu.hub.arcgis.com/>) to gauge your home's flooding risk
- ✓ Identify higher ground
 - Plan your evacuation route or routes
 - Call 800-432-2080 if you know you will need assistance should an evacuation be needed (for example, elderly, people with a disability or no transportation)
- ✓ Know where your nearest emergency shelters are located
- ✓ Build an emergency kit for each person with enough supplies to last 3 days that includes food, water, clothes, important documents and medicine
- ✓ Pack food and water for pets

WATCH: BE READY

Prepare yourself and your family to evacuate (rain is forecasted for the next 24 hours)

- ✓ Identify who in your household will round up the pets, grab the emergency kit, etc.
- ✓ Place all important documents, valuables, needed items in vehicles in preparation for evacuations
- ✓ Make sure everyone knows where to meet
- ✓ Follow local media, local flooding alerts, and county emergency notifications
- ✓ Those who need assistance will be evacuated at this time. If you have not already, contact 800-432-2080 to request assistance in the event evacuation is necessary.



You will not be able to request assistance in evacuating once there is "extreme" flooding danger.

WARNING: LEAVE NOW

Evacuate immediately if told to do so by local officials. Significant rain is forecast for your area or is expected soon. Don't wait!

- ✓ Evacuate immediately if told to do so by local officials.
- ✓ **IF EVACUATION IS NOT POSSIBLE, SEEK HIGHER GROUND – GET ON THE ROOF OF A CAR OR A HOME IF NECESSARY**
- ✓ DO NOT attempt to cross flooded roadways on foot or in a vehicle. If you come across a flooded roadway, turn around and search for higher ground
- ✓ Local officials will communicate with you about where to find shelters
- ✓ **TAKE WARNINGS SERIOUSLY!**



DO NOT WAIT UNTIL THIS WARNING TO REQUEST ASSISTANCE FROM AUTHORITIES



HOW TO TURN ON SEVERE WEATHER ALERTS ON YOUR ANDROID

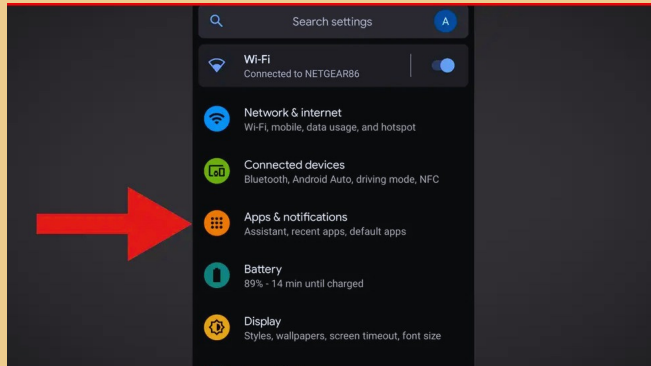

STEP 1
IN "SETTINGS," FIND APPS AND NOTIFICATIONS

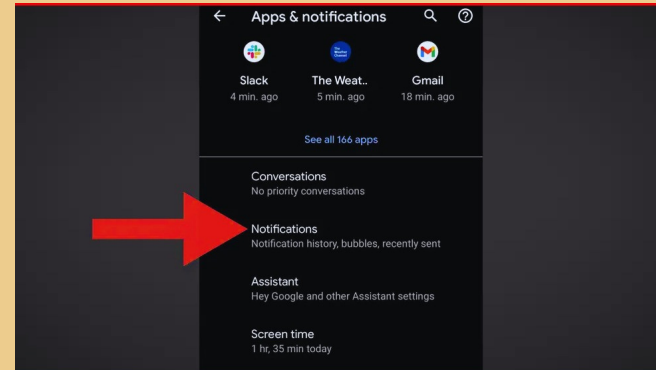

STEP 2
TAP "NOTIFICATIONS."

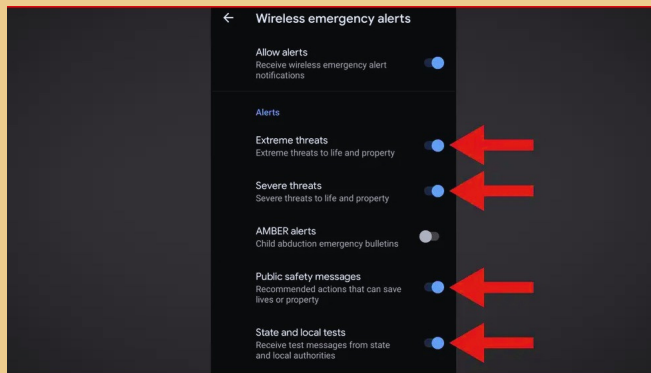

STEP 3
NEXT, TURN ON "ALLOW ALERTS."

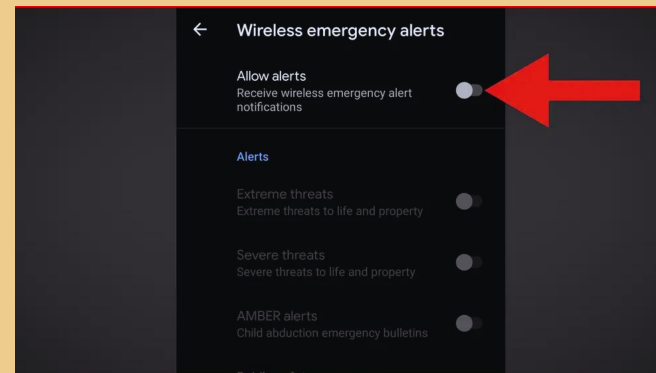

STEP 4
MAKE SURE EACH OF THE ALERT TYPES ARE ENABLED.

Visit www.nmdhsem.org for more information, or call the state's Fire Resources Hotline at 800-432-2080.



HOW TO TURN ON SEVERE WEATHER ALERTS ON YOUR iPhone

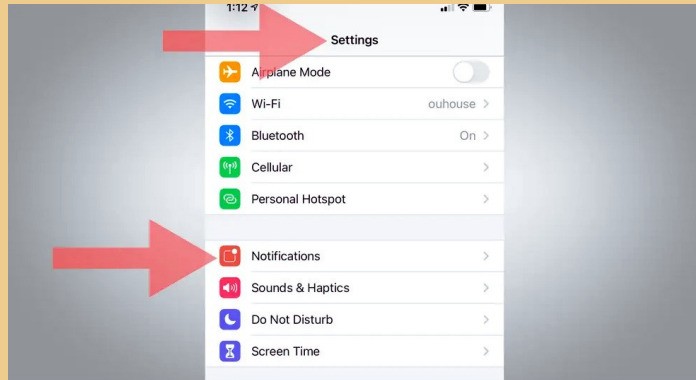

STEP 1
TAP "SETTINGS" AND THEN
"NOTIFICATIONS"

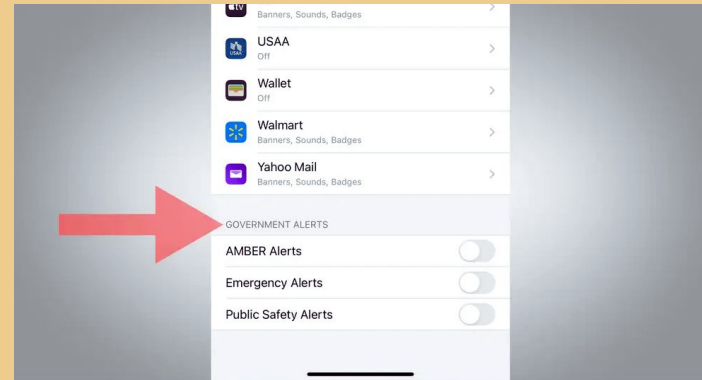

STEP 2
SCROLL TO "GOVERNMENT ALERTS" AT
THE BOTTOM OF THE SCREEN.

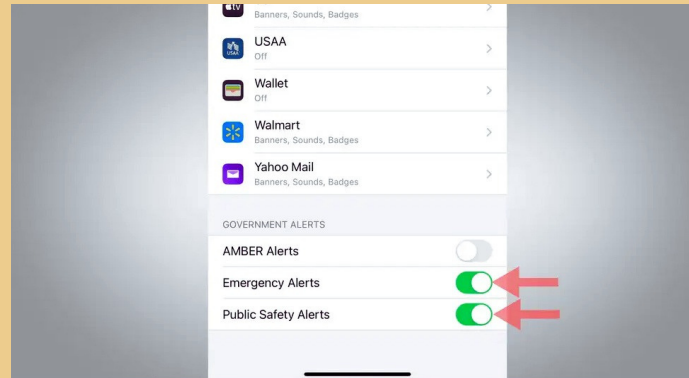

STEP 3
CHECK THAT "EMERGENCY ALERTS" AND
"PUBLIC SAFETY ALERTS" ARE TURNED
ON.

Visit www.nmdhsem.org for more information, or call the state's
Fire Resources Hotline at 800-432-2080.



PREPARE FOR FLASH FLOODING NOW

Burned out areas are at high risk for flash flooding; even a distant rainstorm can quickly flood your location

STAY AHEAD OF DISASTER and MAKE A PLAN

Closely monitor a weather radio for real time weather conditions

- Monitor the weather through TV, radio, reliable social media channels and phones. Use a weather radio for real-time weather conditions
- Plan evacuation routes
- Identify higher ground
- Know where to shelter

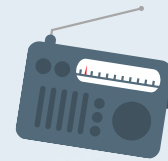

BUILD AN EMERGENCY KIT

Have a basic supply kit ready to go with enough supplies to last each family member at least 3 days, including:

- Food and water
- Change of clothes
- Important documents
- Medicine
- Pets and pet supply needs

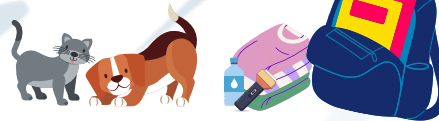

MAKE SURE EVERYONE IN YOUR HOME KNOWS WHAT TO DO DURING A FLASH FLOOD EMERGENCY

- Identify who will round up the pets, grab the emergency kit, etc.
- Make sure everyone knows where to meet
- Create a phone/call tree if necessary



FOLLOW EVACUATION INSTRUCTIONS FROM LOCAL OFFICIALS AND NEWS OUTLETS

- Take warnings seriously. Follow instructions and evacuate immediately if told to do so. Don't Wait!
- DO NOT attempt to cross flooded roadways on foot or in a vehicle. If you come across a flooded roadway, turn around and search for higher ground
- Local officials will communicate with you about where to find shelters



For more information, call the state's Fire Resources Hotline at 800-432-2080 or visit [NM Department of Homeland Security & Emergency | \(nmdhsem.org\)](http://NM Department of Homeland Security & Emergency | (nmdhsem.org))

PREPÁRESE AHORA PARA INUNDACIONES REPENTINAS

Las áreas con terrenos calcinados están en alto riesgo de inundaciones repentinas. Incluso, lluvias que ocurren lejos pueden inundar su área

TOMA EL CONTROL DE LOS DESASTRES y HAGA UN PLAN

Preste atención al radio del tiempo para recibir actualizaciones

- Esté atento a los informes del tiempo en TV, radio, cuentas confiables de redes sociales y teléfonos
- Tenga un radio del tiempo para conocer las condiciones en tiempo real
- Planifique rutas de evacuación
- Conozca dónde refugiarse

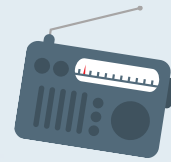

HAGA UN KIT DE EMERGENCIA

Tenga preparado un kit de suministros esenciales con suficientes artículos para cada miembro de la familia que rinda para hasta 3 días

- Comida y agua
- Muda de ropa
- Documentos importantes
- Medicinas
- Mascotas y sus suministros necesarios



ASEGÚRESE DE QUE TODOS EN SU HOGAR SEPAN LO QUE DEBEN HACER DURANTE UNA INUNDACIÓN REPENTINA

- Identifique quién agarrará las mascotas, el kit de emergencia, etc.
- Asegúrese de que todos sepan dónde se encontrarán
- Haga una lista de contactos de emergencia



OBEDEZCA LAS INDICACIONES DE EVACUACIÓN QUE BRINDEN LOS FUNCIONARIOS Y NOTICIEROS LOCALES

- Tome en serio las advertencias. Siga las instrucciones y evacúe inmediatamente si se le indica que lo haga. ¡No espere!
- NO intente cruzar las carreteras inundadas caminando o en un vehículo. Si se encuentra con una carretera inundada, dé la vuelta y busque un terreno más alto.
- Los funcionarios locales se comunicarán con usted sobre dónde encontrar refugios



Para más información, llame a la línea directa de Recursos del Estado por Incendios al 800-432-2080 o visite el Departamento de Seguridad Nacional y Emergencias de NM | (nmdhsem.org)

SISTEMA DE ALERTAS DE INUNDACIÓN

Los terrenos calcinados se encuentran en mayor riesgo de inundaciones repentinas; incluso las lluvias distantes pueden inundar su área rápidamente. Conozca el sistema de alertas y prepárese para desalojar su vivienda.

CÓMO PREPARARSE PARA LA LLUVIA: ESTÉ ATENTO

Prepárese usted y a su familia para la posibilidad de desalojo por inundación

- ✓ Preste atención a las actualizaciones del tiempo en la TV, radio, cuentas confiables en redes social y su teléfono
- ✓ Verifique el mapa de los valles de inundación en su área (<https://hermits-peak-calf-canyon-fire-resources-nmhu.hub.arcgis.com/>) para conocer el riesgo de inundación de su vivienda
- ✓ Identifique un terreno más alto
Planifique su(s) ruta(s) de evacuación
→ Llame al **800-432-2080** si sabe que necesitará ayuda en caso de desalojar su vivienda (p. ej., adultos mayores, tiene una discapacidad o no tiene transporte)
- ✓ Conozca dónde se encuentran los refugios por emergencia más cercanos
- ✓ Haga un kit de emergencia para cada persona con suficientes suministros para al menos tres días, que incluya comida, agua, ropa, documentos importantes y medicinas
- ✓ Empaque comida y agua para sus mascotas

ADVERTENCIA: ESTÉ LISTO

Prepárese usted y a su familia para la posibilidad de desalojo por inundación (se pronostica lluvia durante las próximas 24 horas)

- ✓ Identifique quién será la persona que agarrará las mascotas, el kit de emergencias, etc.
- ✓ Coloque todos los documentos importantes, artículos valiosos y necesarios en los vehículos como preparación para desalojar su vivienda
- ✓ Asegúrese de que todos sepan dónde se encontrarán
- ✓ Preste atención a la prensa, las alertas de inundación locales y notificaciones de emergencias del condado
- ✓ Las personas que necesitan ayuda serán desalojadas en este momento. Si aún no lo ha hecho, comuníquese al **800-432-2080** para pedir ayuda en caso de que sea necesario desalojar su vivienda



No podrá pedir ayuda para desalojar una vez haya un peligro "extremo" de inundación

AVISO: VÁYASE AHORA

Desaloje su vivienda de inmediato si así lo ordenan los funcionarios locales. Se pronostican lluvias intensas en su área u ocurrirán pronto. ¡No espere!

- ✓ Desaloje su vivienda de inmediato si así lo ordenan los funcionarios locales.
- ✓ **SI NO PUEDE DESALOJAR, TRASLÁDESE A TERRENO ALTO - VAYA AL TECHO DE UNA VIVIENDA O DE UN CARRO, SI ES NECESARIO**
- ✓ NO intente atravesar carreteras inundadas caminando ni en su vehículo. Si encuentra una carretera inundada, dé la vuelta y busque terreno más alto
- ✓ Los funcionarios locales se comunicarán con usted sobre dónde encontrar refugio
- ✓ **¡TOME LAS ALERTAS EN SERIO!**



NO ESPERE A QUE SE EMITA EL AVISO PARA SOLICITAR AYUDA DE LAS AUTORIDADES





Consejos sobre bolsas de arena

Resumen de la Guía de Emergencias por Inundación del Distrito de Albuquerque de USACE

¿Cuánto debo llenar mis bolsas de arena?

Usualmente, las bolsas de arena son llenadas a dos tercios y no necesitan amarrarse, aunque pueden amarrarse un poco sueltas en el borde. Deben poder ser recostadas cuando se colocan.

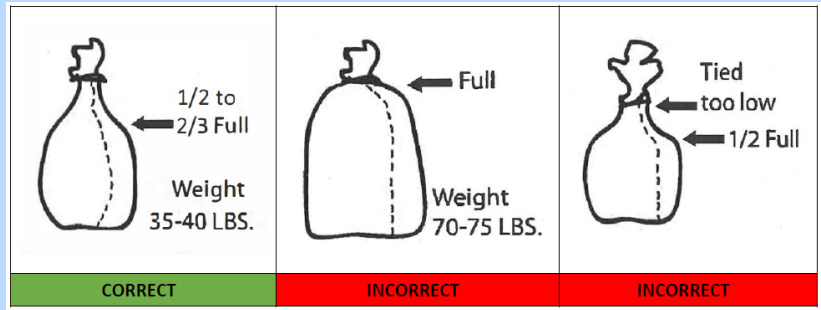

¿Cómo se deben apilar las bolsas de arena?

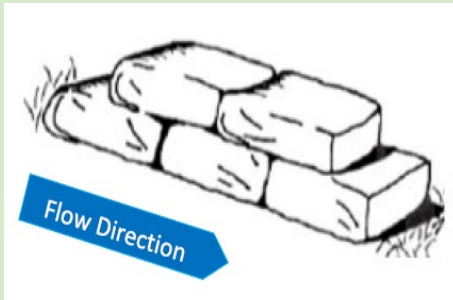

Las bolsas deben colocarse a lo largo y sobreponerse, como ladrillos, paralelas a la dirección de la corriente del río. Los apilamientos de más de 2 bolsas de arena de alto deben colocarse como una pirámide con una base ancha. Para lograr estabilidad, el dique debe ser tan corto y bajo como sea posible. Compacte cada bolsa de arena en su lugar pisándolas. Asegúrese de que cada bolsa esté bien apretada contra la próxima

- Las bolsas de arenas deben ubicarse frente a las puertas y aberturas en mampostería. La mayoría de las viviendas y edificios comunes sobre losa de cemento pueden protegerse con entre 25 a 40 bolsas de arena. Sin embargo, se debe considerar colocar de manera tal que permita la salida en caso de emergencia.
- Las bolsas de arena son básicamente para protección de corriente baja (de hasta 4 pies de altura).
- Las bolsas de arena no sellarán de manera tal que el agua no las atraviese. Conozca los sistemas de alerta temprana de inundación y desaloje su vivienda inmediatamente si los funcionarios así lo ordenan.



Summarized from USACE-Albuquerque District Flood Emergency Handbook

How much do I fill my sandbags?

Typically, sandbags are filled approximately half to two thirds full and **do not need** to be tied, although they may be tied loosely near the top. They should be able to lay flat when placed.

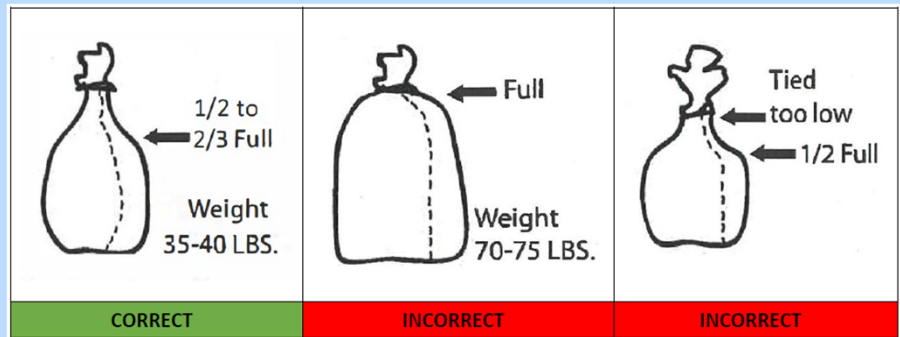

How should I stack my sandbags?

The bags should be placed lengthwise and overlapped, like bricks, parallel to the direction of the river flow. Any stack more than 2 sandbags tall should be built like a pyramid with a wide base. For stability, the levee should be kept as short and low as possible. Compact each sandbag in place by stepping/walking on it. Make sure the bag is snugly butted against the next bag.

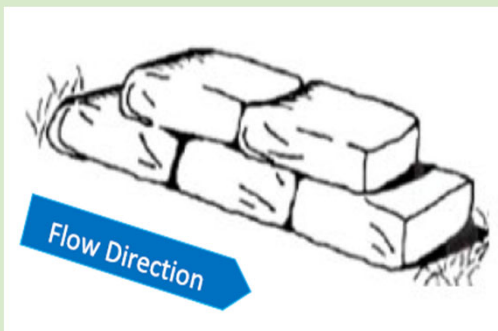

- **Sandbags should also be used in front of doorways/roller doors and brickwork vents.** Most standard homes and buildings on a concrete slab can be protected with between 25-40 sandbags. However, consideration should be given to placing the closure in such a way as to allow for egress in case of emergency.
- **Sandbags are basically for low-flow protection (up to 4 feet high).**
- **Sandbags will not totally seal out water.** Know your early flood warning systems and evacuate immediately if told to do so by officials.